

DOOR TYPE SCHEDULE							
KEYNOTE	DOOR TYPE	CONSTRUCTION	H x W	FUNCTION	FRL	COUNT	NOTES
D.01	SECURE GARAGE ROLLER DOOR	STEEL POWDERCOATED GARAGE DOOR - MEASURE ON SITE	2400 x 6000	Exterior	--/--/--	1	
D.02	FIRE EXIT DOOR	45mm FLUSH SOLID CORE DOOR WITH STEEL JAMBS	2100 x 920	Interior	--/90/30 min	27	
D.02a	FIRE DOOR	45mm FLUSH SOLID CORE DOOR WITH STEEL JAMBS	2100 x 920	Interior	--/120/30	1	
D.02b	FIRE DOOR	35mm FLUSH SOLID CORE DOOR WITH STEEL JAMBS	2100 X 920	Interior	--/60/30 min	3	
D.03	FIRE EXIT DOOR	45mm FLUSH SOLID CORE DOOR WITH STEEL JAMBS	2700 x 920	Interior	--/90/30 min	1	
D.04	APT ENTRY - FIRE DOOR	35mm FLUSH SOLID CORE DOOR WITH STEEL JAMBS - SELF CLOSING	2400 x 820	Interior	--/60/30 min	54	MIN R _w 30 ACOUSTIC RATING BETWEEN SOU & LOBBY, HALLWAY, WALKWAY OR OTHER COMMON AREA
D.05	APT ENTRY - FIRE DOOR	35mm FLUSH SOLID CORE DOOR WITH STEEL JAMBS - SELF CLOSING	2400 x 1020	Exterior	--/60/30 min	18	
D.05a	STANDARD INTERNAL HOLLOWCORE DOOR	35mm FLUSH HOLLOWCORE DOOR	2100 x 1020	Interior	--/--/--	34	
D.06	INTERNAL DOUBLE DOOR - FIRE DOOR	45mm FLUSH SOLID CORE DOOR WITH STEEL JAMBS	2100 x 1840	Interior	--/90/30 min	1	
D.07	INTERNAL DOUBLE DOOR - COMMS JOINERY DOOR	35mm FLUSH SOLID CORE DOOR	2400 x 1200	Interior	--/--/--	11	
D.08	WASTE ROOM DOUBLE DOOR	35mm FLUSH SOLID CORE DOOR	2400 x 1600	Exterior	--/--/--	1	
D.08a	PLANT ROOM DOUBLE DOOR	35mm FLUSH SOLID CORE DOOR WITH STEEL JAMBS	2400 x 1600 FR	Exterior	--/60/30 min	1	
D.09	LOUVRED DOOR - GAS METER ROOM	35mm SOLID DOOR WITH LOUVRED GRILLES	2700 x 920	Exterior	--/--/--	1	
D.10	LOUVRED DOUBLE DOOR - TRANSFORMER ROOM	4000 X 4000	4000 X 4000	Interior	--/--/--	1	
D.11	STANDARD INTERNAL	35mm FLUSH HOLLOWCORE DOOR	2100 x 620	Interior	--/--/--	18	
D.12	STANDARD INTERNAL	35mm FLUSH HOLLOWCORE DOOR	2100 x 720	Interior	--/--/--	83	
D.13	STANDARD INTERNAL	35mm FLUSH HOLLOWCORE DOOR	2100 x 820	Interior	--/--/--	79	

REFER TO ACOUSTIC ASSESSMENTS BY VIPAC ENGINEERS FOR REQUIRED R_w TO EACH GLAZING UNIT

PRIOR TO WINDOW AND DOOR INSTALLATION, CONTRACTOR TO PROVIDE EVIDENCE OF CERTIFICATION FOR ACOUSTIC COMPLIANCE WITH VIPAC ACOUSTIC ASSESSMENT - MINISTER'S SPECIFICATION 78B DATED 24/MAY/2019

NOTE: ALL WINDOW & DOOR SIZES AND DIMENSIONS TAKEN FROM OPENINGS IS THE SIZE OF GLAZING UNIT AND TOLERANCE SHOULD BE ALLOWED FOR IN WIDTH AND HEIGHT FOR WALL OPENING SIZES

DOOR TYPE SCHEDULE							
KEYNOTE	DOOR TYPE	CONSTRUCTION	H x W	FUNCTION	FRL	COUNT	NOTES
D.14	STANDARD INTERNAL	35mm FLUSH SOLID CORE DOOR	2400 x 720	Interior	--/--/--	2	
D.15	STANDARD INTERNAL	35mm FLUSH SOLID CORE DOOR	2400 x 820	Interior	--/--/--	19	
D.16	STANDARD INTERNAL	35mm FLUSH SOLID CORE DOOR	2400 x 870	Interior	--/--/--	9	
D.17	STANDARD INTERNAL	35mm FLUSH SOLID CORE DOOR	2400 x 920	Interior	--/--/--	4	
D.18	CAVITY SLIDING INTERNAL	35mm FLUSH SOLID CORE DOOR	2400 x 820	Interior	--/--/--	9	
D.19	CAVITY SLIDING INTERNAL	35mm FLUSH SOLID CORE DOOR	2400 x 920	Interior	--/--/--	7	
D.19a	STANDARD INTERNAL SOLID CORE DOOR WITH CAVITY UNIT	35mm FLUSH HOLLOWCORE DOOR	2100 x 1100	Interior	--/--/--	25	
D.20	COLORBOND GATE	STEEL FRAMED GATE WITH SELECTED SHEETING AND GATE LATCH	1800 x 800	Interior	--/--/--	1	
D.21	SLIDING GLASS DOOR - 2 PANEL	ALUMINIUM FRAMED DOUBLE GLAZED UNIT	2400 x 1800	Exterior	--/--/--	3	
D.22	SLIDING GLASS DOOR - 2 PANEL	ALUMINIUM FRAMED DOUBLE GLAZED UNIT	2400 x 2100	Exterior	--/--/--	18	
D.23	SLIDING GLASS DOOR - 3 PANEL	ALUMINIUM FRAMED DOUBLE GLAZED UNIT - NO MULLION	2400 x 3150	Exterior	--/--/--	5	
D.24	SLIDING GLASS DOOR - 2 PANEL	ALUMINIUM FRAMED DOUBLE GLAZED UNIT - NO MULLION	2700 x 2100	Exterior	--/--/--	1	
D.25	SLIDING GLASS DOOR - 2 PANEL	ALUMINIUM FRAMED DOUBLE GLAZED UNIT	2700 x 2100	Exterior	--/--/--	48	
D.26	SLIDING GLASS DOOR - 2 PANEL	ALUMINIUM FRAMED DOUBLE GLAZED UNIT	3000 x 2100	Exterior	--/--/--	7	
D.27	SLIDING GLASS DOOR - 2 PANEL	ALUMINIUM FRAMED DOUBLE GLAZED UNIT	3000 x 2700	Exterior	--/--/--	4	
D.28	SLIDING GLASS DOOR - 3 PANEL	ALUMINIUM FRAMED DOUBLE GLAZED UNIT	2700 x 3150	Exterior	--/--/--	16	
D.29	SLIDING GLASS DOOR - 4 PANEL	ALUMINIUM FRAMED DOUBLE GLAZED UNIT	3000 x 4800	Exterior	--/--/--	4	
D.30	SLIDING GLASS DOOR - 4 PANEL - AUTOMATIC	ALUMINIUM FRAMED DOUBLE GLAZED UNIT	2700 x 5000	Exterior	--/--/--	1	
D.31	SWING GLASS DOOR	ALUMINIUM FRAMED DOUBLE GLAZED UNIT	2400 x 820	Exterior	--/--/--	2	
D.32	SWING GLASS DOOR TO POOL AREA - SWING OUTWARDS	ALUMINIUM FRAMED DOUBLE GLAZED UNIT WITH FLUSH SILL/NO SILL	2400 x 1020	Exterior	--/--/--	1	ALLOW MIN 550mm LATCH CLEARANCE IN ACCORDANCE WITH AS1428.1-2009. DOOR HANDLE TO BE INSTALLED 1500mm AFL IN ACCORDANCE WITH AS1926.1 - SAFETY BARRIERS FOR SWIMMING POOLS. REFER D.34 NOTE BELOW FOR CONSTRUCTION DETAILS
D.33	SWING GLASS DOOR	ALUMINIUM FRAMED DOUBLE GLAZED UNIT	2700 x 900	Exterior	--/--/--	4	
D.34	SWING GLASS DOOR	ALUMINIUM FRAMED DOUBLE GLAZED UNIT WITH FLUSH SILL/NO SILL	2700 x 1020	Interior	--/--/--	1	
D.35	DOUBLE SWING GLASS DOOR	ALUMINIUM FRAMED DOUBLE GLAZED UNIT WITH FLUSH SILL/NO SILL	2700 x 1810	Interior	--/--/--	3	
D.36	BIFOLD GLASS DOOR - 3 PANEL	ALUMINIUM FRAMED DOUBLE GLAZED UNIT	3500 x 2950	Exterior	--/--/--	3	
D.37	SWING GLASS DOOR	ALUMINIUM FRAMED GLAZED UNIT - NO SILL	2040 x 820	Interior	--/--/--	5	

537

WASTE CHUTE HOPPER DOORS AND RISER FIRE RATED MIN 1 HOUR

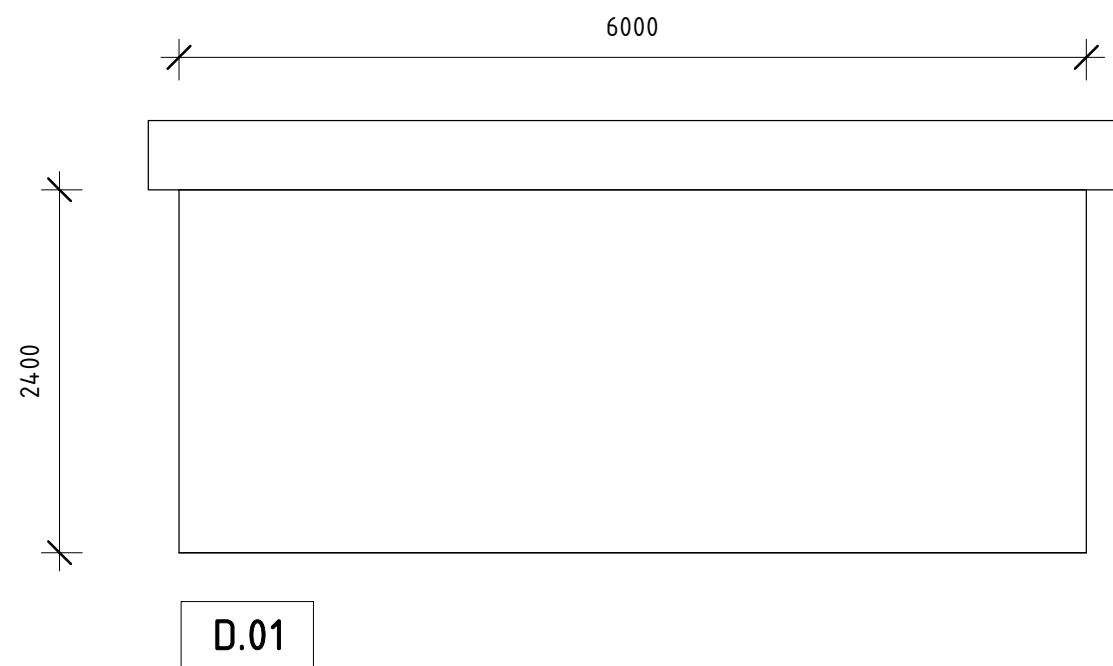

D.34 TO POOL ENCLOSURE - MUST BE CONSTRUCTED OF TOUGHENED SAFETY GLASS AS DEFINED IN AS1288 AND CAPABLE OF RESISTING SMOKE AT 200C FOR 30 MINS. MUST BE CONSTRUCTED IN ACCORDANCE WITH NCC VOL 1 SPEC C3.4 CLAUSE 3 "SMOKE DOORS"

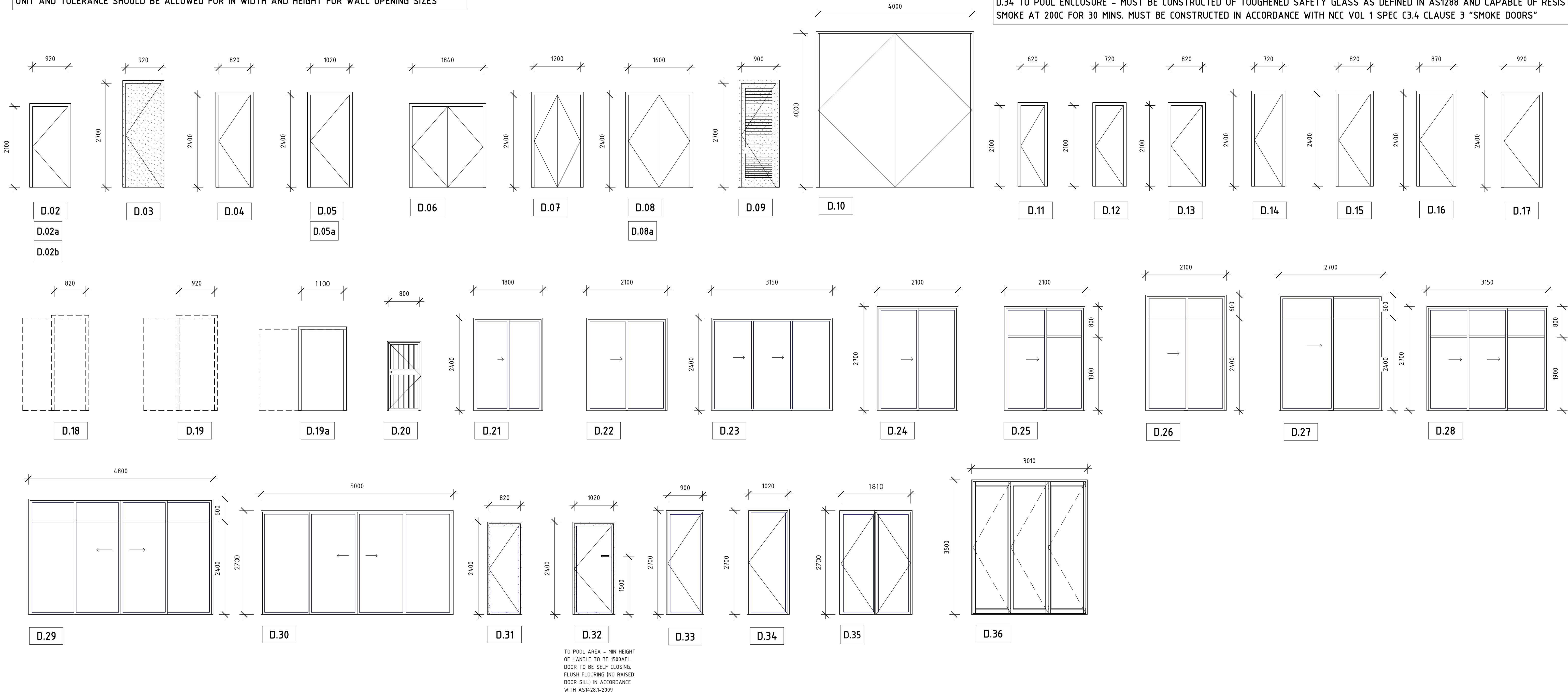

REVISIONS		
ISSUE #	DATE	DESCRIPTION
A	25/03/2019	FOR BRC APPROVAL
B	14/05/2019	REVISED SET BASED ON BRC RFI PCS9515
D	29/06/2019	FOR TENDER & BRC
E	27/09/2019	FOR CONSTRUCTION - CORRECTED SITE SURVEY
M	09/03/2020	VARIOUS AS CLOUDED

PROJECT ADDRESS
248 UNLEY ROAD HYDE PARK

HYDE PARK PLACE - STAGE A

CLIENT
HYDE PARK PLACE PTY LTD

CITIFY bfc

SHEET
DOOR SCHEDULE

WD.A.600

AUTHOR
GB

REVISION DESCRIPTION
VARIOUS AS CLOUDED

ISSUE DATE
08/05/2020

FOR CONSTRUCTION

GEMMA

LEA
DESIGN STUDIO